



181 US Hwy 46
Mine Hill, NJ 07803
(908) 654-8068
(800) 783-0567
Fax 908-654-8069

LEAD IN DRINKING WATER REPORT

Performed At:

Alexander Hamilton Elementary School,
Central Elementary School,
Clara E. Coleman Elementary School,
Glen Rock Middle/High School,
Richard E. Byrd Elementary School

Performed For:

Glen Rock Board of Education
Donald Mutch, CEFM
620 Harristown Rd
Glen Rock, NJ 07452

Prepared By:

LEW Corporation
181 US Hwy 46
Mine Hill, NJ 07803

Phone (908) 654-8068
Fax (908) 654-8069
Website <http://www.LEWCorp.com>

Inspection Date: 3/12/2022 8:00 AM
Project Number: 220156

Table of Contents

Contact Information	3
Introduction	4
Sampling Methodology	4
Drinking Water Results	5
Recommendations	6
Additional Recommendations	6

Appendices

Appendix A	Exceedances
Appendix B	Recommendations
Appendix C	All results
Appendix D	Floor Plan(S)
Appendix E	Laboratory Data

Contact Information

Agency

Client Contact:	Donald Mutch, CEFM
Client Name:	Glen Rock Board of Education
Street Address	620 Harristown Rd Glen Rock, NJ 07452
Phone Number:	(201) 445-7700 x8927

Risk Assessor(s)

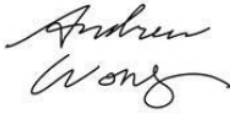
Site Assessor(s):	Andrew Wong
License:	LBP-I-1220843-1
Signature:	
Date:	March 12, 2022
E-Mail	awong@lewcorp.com

Firm

Organization:	LEW Corporation
Certification #:	NJDCA 00015 E
Street:	181 US Hwy 46
City, State & Zip:	Mine Hill, NJ 07803
Phone Number:	908-654-8068
Web Address:	http://www.lewcorp.com

Laboratory

Organization:	Environmental Hazard Services, LLC
Street:	7469 Whitepine Road
City, State & Zip:	Richmond, VA 23237
NJDEP Certification #	VA008
Phone Number:	800-347-4010

Introduction

LEW Corporation was contracted by Glen Rock Board of Education to test for the presence of lead in drinking water from five schools in the district.

Sampling Methodology

LEW Corporation followed the July 13, 2016 amendments to NJAC 6A:26. Full details on sampling practices can be found in Districts Sampling Plan.

All samples were collected in 250mL wide mouth plastic containers that was prepackaged by the analytical laboratory. The sample containers may contain nitric acid, if expedited analysis is required. If not, nitric acid will be added to each sample upon arrival at the laboratory. At each sample location, the first draw sample was taken after it was determined that the water had been standing in the plumbing system for greater than eight hours but less than forty-eight hours. If second draw samples were collected, they were collecting following a flushing protocol outlined in the District's Sampling Plan.

Drinking Water Results

On March 12, 2022, LEW Corporation collected the following number of water samples:

Alexander Hamilton Elementary School

- 7 first draw samples collected
- 0 samples above the 15ppb action level

Central Elementary School

- 10 first draw samples
- 0 samples above the 15ppb action level

Clara E. Coleman Elementary School

- 11 first draw samples
- 0 samples above the 15ppb action level
-

Glen Rock High/Middle School

- 16 first draw samples
- 0 samples above the 15ppb action level

Richard E. Byrd Elementary School

- 9 first draw samples
- 0 samples above the 15ppb action level

The complete list of samples that exceeded the 15ppb limit can be found in Appendix A. The complete list of all sample results can be found in Appendix C. The laboratory results can be found in Appendix E.

Certain outlets could not or were not tested due to various reasons. The following table lists those locations and the reason why samples were not collected.

School	Sample Location	Reason for not testing.
Alexander Hamilton Elementary School	Bottle Fill – Outside Nurse’s Office	A bottle fill was supposed to be installed, but it never was; there is a water fountain in the location, but it is not operational.
Glen Rock High/Middle School	Sink – Concession Stand	Turned off. Likely that this was not the intended outlet: sink 3 is supposed to be in the home economics classroom.

Recommendations

Those outlets where the first draw sample tested below 15ppb are not considered to be elevated and no mitigation is necessary.

For those outlets where the first draw sample exceeds 15ppb the following steps are recommended:

- 1) Immediately discontinue use of the outlets.
- 2) Conduct second draw (flush) samples on these outlets to further delineate source of contamination.

A complete list of recommendations per outlet can be found in Appendix B.

Additional Recommendations

- 1) Follow-up samples should be collected after any remediation efforts in order to determine the efficacy of the work.
- 2) Any of the inoperable/non-functioning outlets listed above that are brought back into service should be sample.
- 3) Comply with all requirements set forth in NJAC 6A:26.

Appendix A Exceedances (if applicable)

Appendix B Recommendations (if applicable)

Appendix C All Results

Project Name	Client Sample	Sample Description	Concentration (ug/L)	Date Sampled
Alexander Hamilton Elementary School	AH-S3-NO	Sink in Nurse's Office	<1.00	03/12/22
Alexander Hamilton Elementary School	AH-S2-MO	Sink in Main Office	<1.00	03/12/22
Alexander Hamilton Elementary School	AH-S4-126	Sink in Classroom 126	<1.00	03/12/22
Alexander Hamilton Elementary School	AH-S5-124	Sink in Classroom 124	<1.00	03/12/22
Alexander Hamilton Elementary School	AH-S1-FR	Sink in Faculty Room	<1.00	03/12/22
Alexander Hamilton Elementary School	AH-BF2-SB	Bottle Fill next to Student Bathroom	<1.00	03/12/22
Alexander Hamilton Elementary School	AH-S-SR	Sink in Sunroom	<1.00	03/12/22
Central Elementary School	CS-BF1-RM103	Bottle Fill outside Room 103	<1.00	03/12/22
Central Elementary School	CS-S4-RM100	Sink in Room 100	1.03	03/12/22
Central Elementary School	CS-S5-RM101	Sink in Room 101	1.31	03/12/22
Central Elementary School	CS-S1-NO	Sink in Nurse's Office	<1.00	03/12/22
Central Elementary School	CS-BF3-RM212	Bottle Fill outside Room 212	<1.00	03/12/22
Central Elementary School	CS-BF2-	Bottle Fill outside	<1.00	03/12/22

School	RM205	Room 205		
Central Elementary School	CS-S2-215	Sink in Classroom 215	<1.00	03/12/22
Central Elementary School	CS-S3-214	Sink in Classroom 214	<1.00	03/12/22
Central Elementary School	CS-BF4-RM306	Bottle Fill outside Room 306	<1.00	03/12/22
Central Elementary School	CS-S-SR	Sink in Sunroom	<1.00	03/12/22
Clara E. Coleman Elementary School	CES-BF3-FR	Bottle Fill outside Faculty Room	<1.00	03/12/22
Clara E. Coleman Elementary School	CES-S7-FR	Sink in Faculty Room	1.16	03/12/22
Clara E. Coleman Elementary School	CES-S1-NO	Sink in Nurse's Office	2.95	03/12/22
Clara E. Coleman Elementary School	CES-S2-RMK2	Sink in Classroom K2	<1.00	03/12/22
Clara E. Coleman Elementary School	CES-S3-RMK1	Sink in Classroom K1	<1.00	03/12/22
Clara E. Coleman Elementary School	CES-S4-K	Sink in Kitchen	3.05	03/12/22
Clara E. Coleman Elementary School	CES-S5-RM5	Sink in Classroom 5	<1.00	03/12/22
Clara E. Coleman Elementary School	CES-S6-RM4A	Sink in Classroom 4A	<1.00	03/12/22
Clara E. Coleman Elementary School	CES-BF2-RM11	Bottle Fill outside Room 11	<1.00	03/12/22
Clara E. Coleman Elementary School	CES-BF1-MC	Bottle Fill outside Media Center	<1.00	03/12/22
Clara E. Coleman	CES-S-SR	Sink in Sunroom	<1.00	03/12/22

Elementary School				
Glen Rock Middle/High School	GRHS-BF6- PO	Bottle Fill outside Principal's Office	<1.00	03/12/22
Glen Rock Middle/High School	GRHS-BF1- NO	Bottle Fill outside Nurse's Office	<1.00	03/12/22
Glen Rock Middle/High School	GRHS-S1- CAF	Sink in Cafeteria	1.19	03/12/22
Glen Rock Middle/High School	GRHS-S5- CAFG	Sink in Cafeteria	3.12	03/12/22
Glen Rock Middle/High School	GRHS-S7- CS	Sink in Child's Study	<1.00	03/12/22
Glen Rock Middle/High School	GRHS-S8- WR	Sink in Work room	<1.00	03/12/22
Glen Rock Middle/High School	GRHS-BF2- GL	Bottle Fill outside Gym Lobby	<1.00	03/12/22
Glen Rock Middle/High School	GRHS-BF7- 116	Bottle Fill outside S116	<1.00	03/12/22
Glen Rock Middle/High School	GRHS-S2- HE	Sink in Home Economics	<1.00	03/12/22
Glen Rock Middle/High School	GRHS-S3- HE	Sink in Home Economics	<1.00	03/12/22
Glen Rock Middle/High School	GRHS-BF3- MSG	Bottle Fill outside Middle School Gym	<1.00	03/12/22
Glen Rock Middle/High School	GRHS-S4- MSFR	Sink in Middle School Faculty Room	<1.00	03/12/22
Glen Rock Middle/High School	GRHS-BF4- A210	Bottle Fill outside Room A210	<1.00	03/12/22
Glen Rock	GRHS-BF5-	Bottle Fill Outside	<1.00	03/12/22

Middle/High School	S232	Room S232		
Glen Rock Middle/High School	GRHS-S8- SHOP	Shop Sink	<1.00	03/12/22
Glen Rock Middle/High School	GRHS-S- SR	Sink in Sunroom	<1.00	03/12/22
Richard E. Byrd Elementary School	BES-S1- CAFÉ	Sink in First Floor Café	1.17	03/12/22
Richard E. Byrd Elementary School	BES-BF1- 1FLR	Bottle Fill in middle of First Floor	<1.00	03/12/22
Richard E. Byrd Elementary School	BES-BF2- RM212	Bottle Fill outside Room 212	<1.00	03/12/22
Richard E. Byrd Elementary School	BES-BF3- RM209	Bottle Fill outside Room 209	<1.00	03/12/22
Richard E. Byrd Elementary School	BES-S2-CR	Sink in Copy Room	<1.00	03/12/22
Richard E. Byrd Elementary School	BES-S3-FR	Sink in Faculty Room	<1.00	03/12/22
Richard E. Byrd Elementary School	BES-S4-NO	Sink in Nurse's Office	2.38	03/12/22
Richard E. Byrd Elementary School	BES-BF4- 304	Bottle Fill outside Room 304	<1.00	03/12/22
Richard E. Byrd Elementary School	BES-S-SR	Sink in Sunroom	<1.00	03/12/22

Appendix D Floor Plan(s)

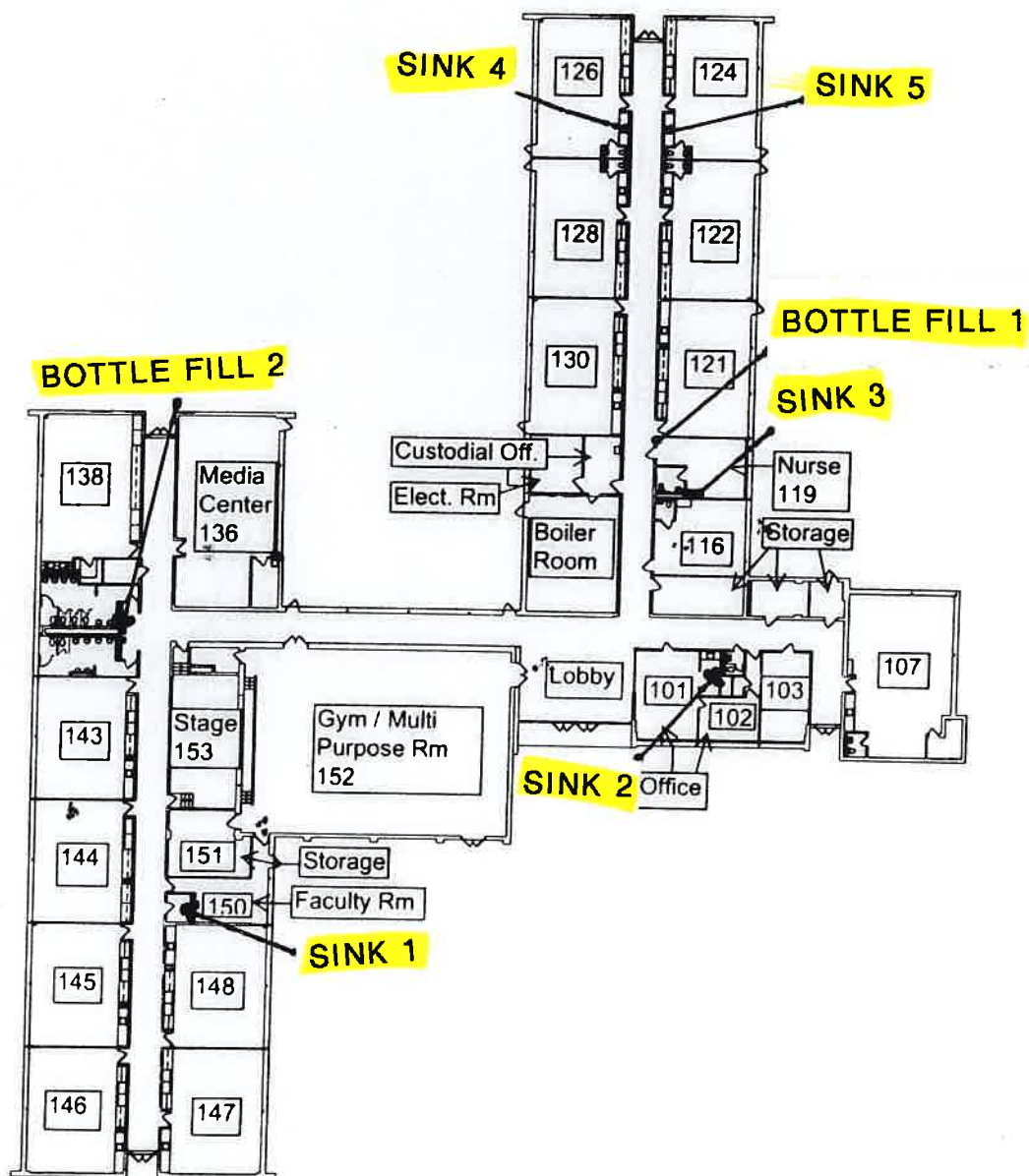

HAMILTON E.S.
GROUND FLOOR

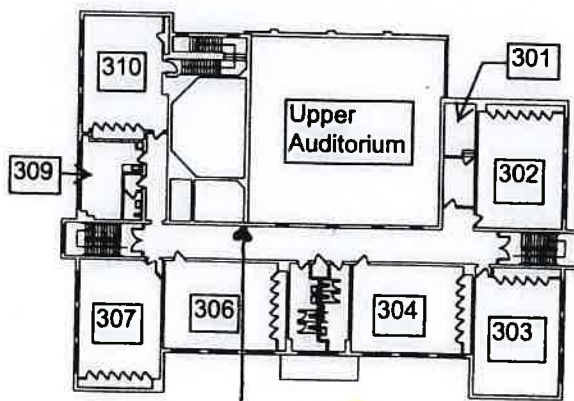

CENTRAL E.S.
SECOND FLOOR

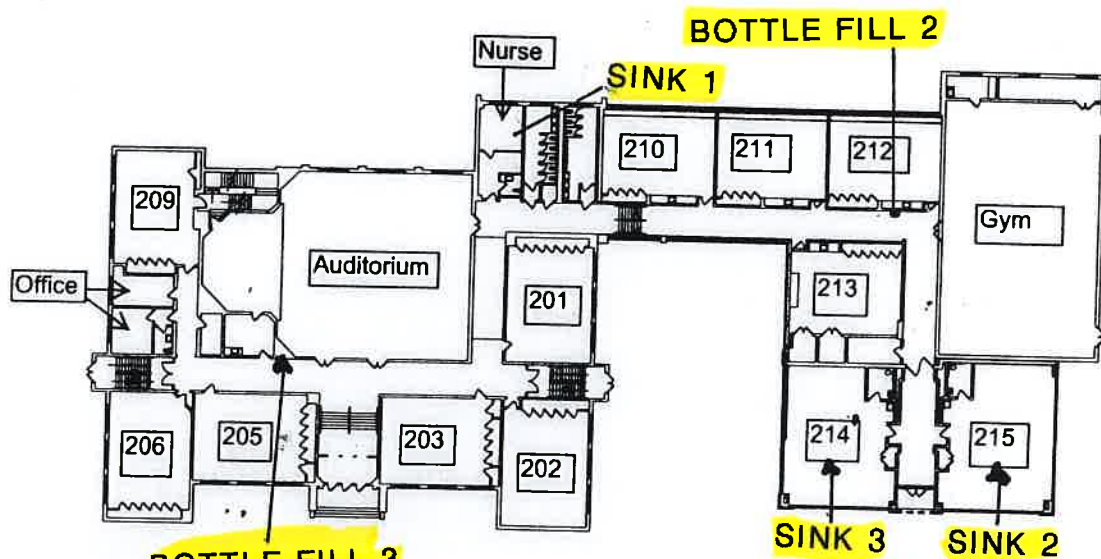

CENTRAL SCHOOL
GROUND FLOOR

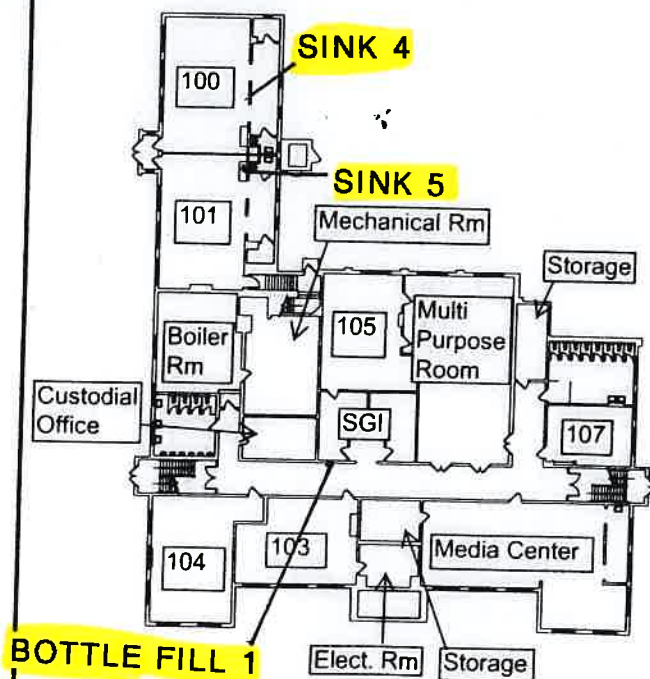

CENTRAL SCHOOL
LOWER LEVEL

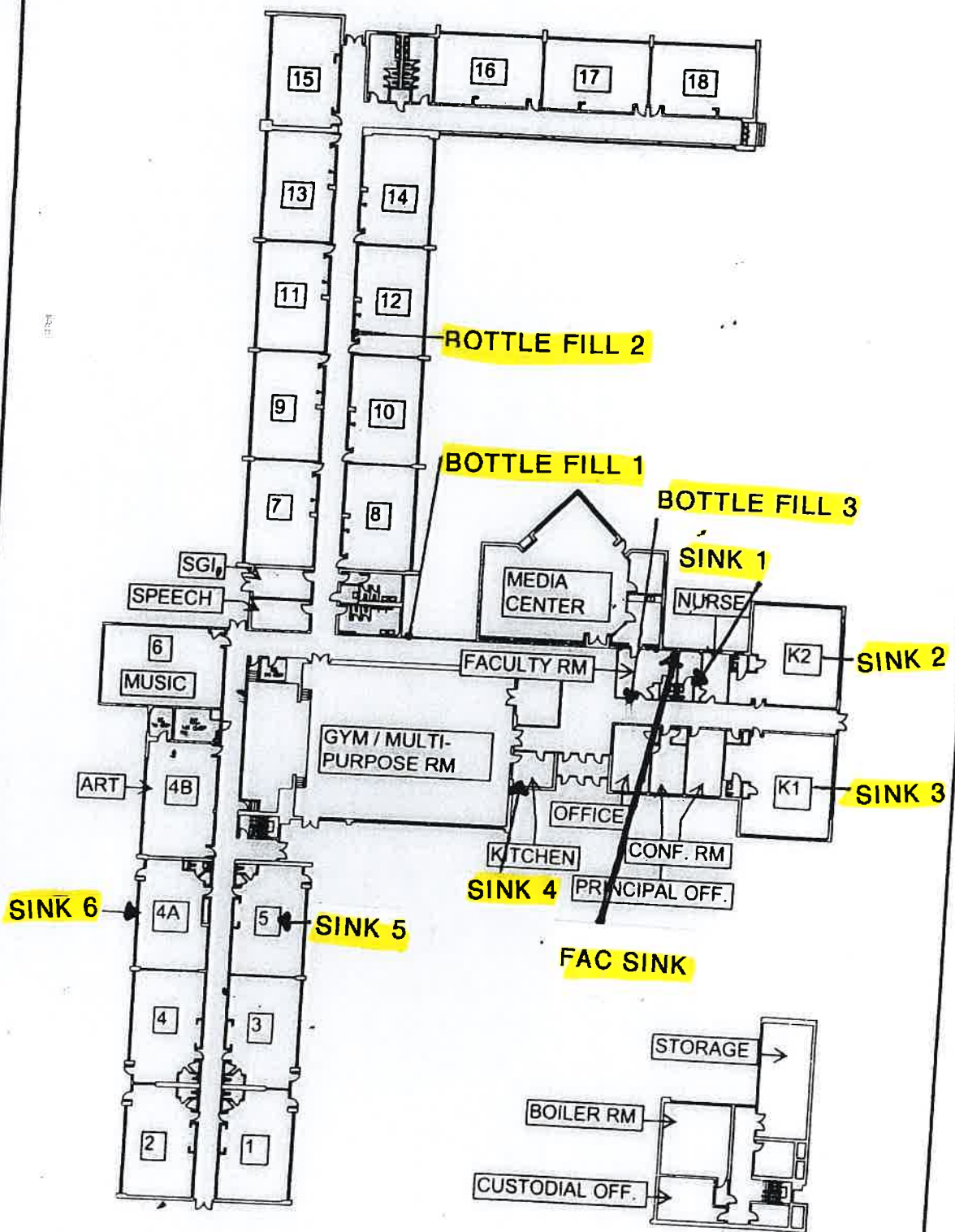

COLEMAN E.S.
GROUND FLOOR

COLEMAN E.S.
LOWER LEVEL

MS/HS LOWER LEVEL

GLEN ROCK HS/MS LOWER LEVEL

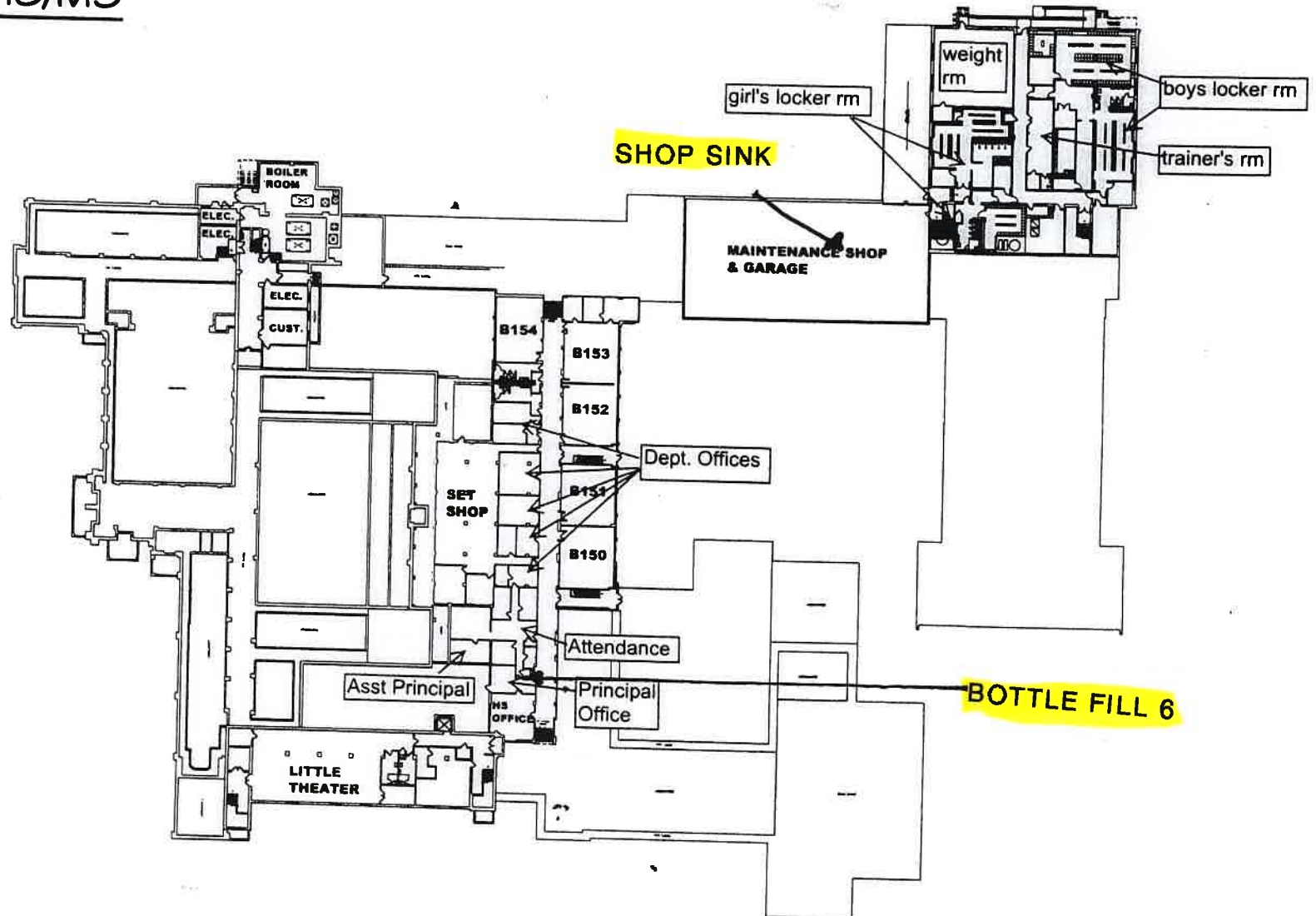

GLEN ROCK HS/MS **BOTTLE FILL 7**
GROUND FLOOR

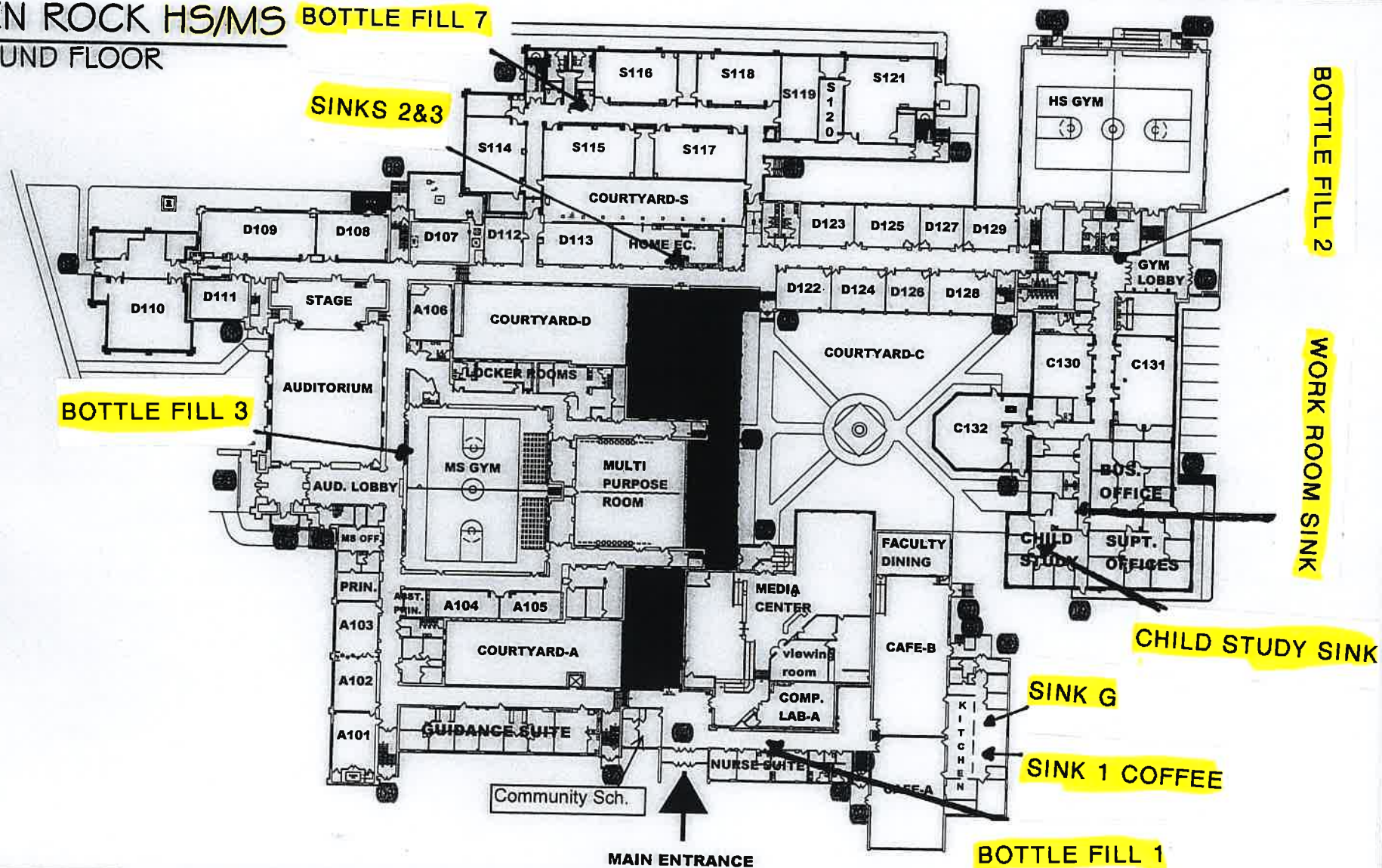

GLEN ROCK HS/MS

SECOND FLOOR

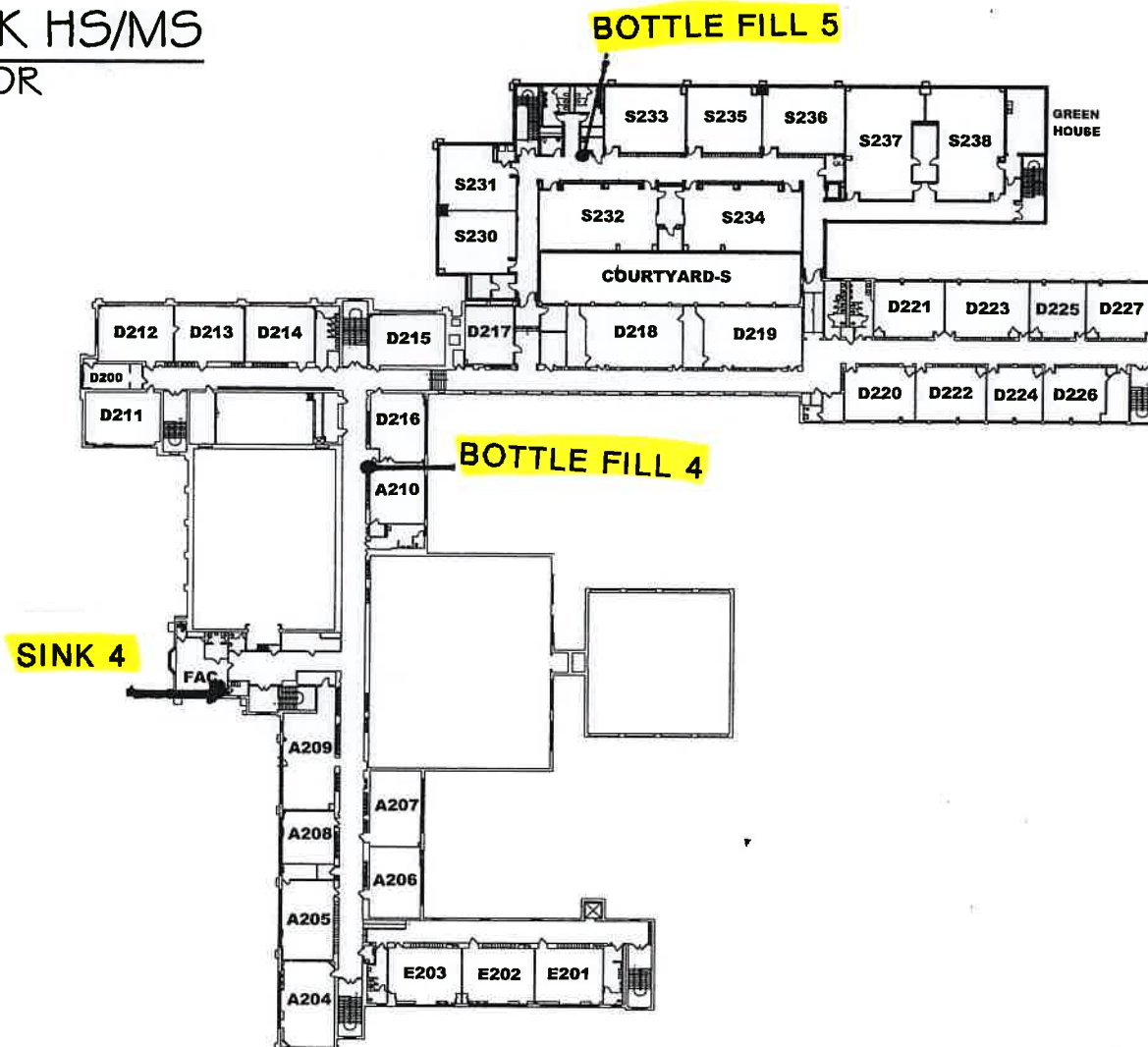

BYRD E.S.
SECOND FLOOR

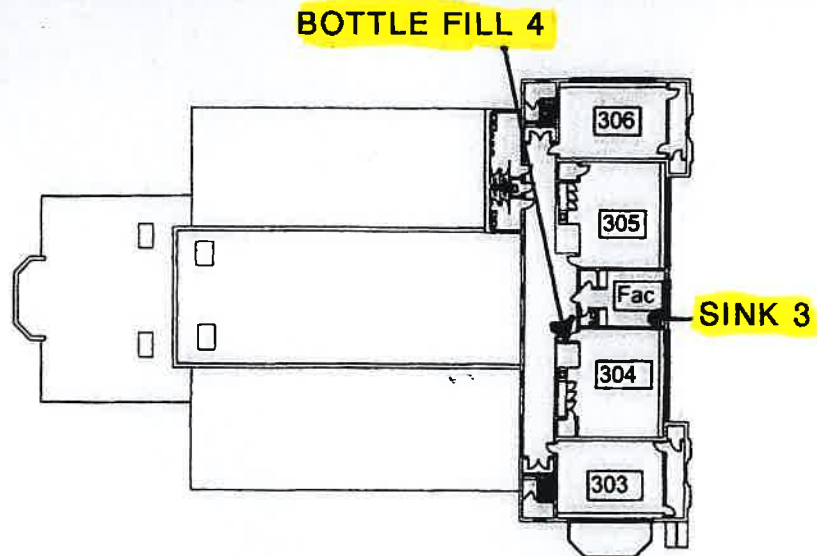

BYRD E.S.
GROUND FLOOR

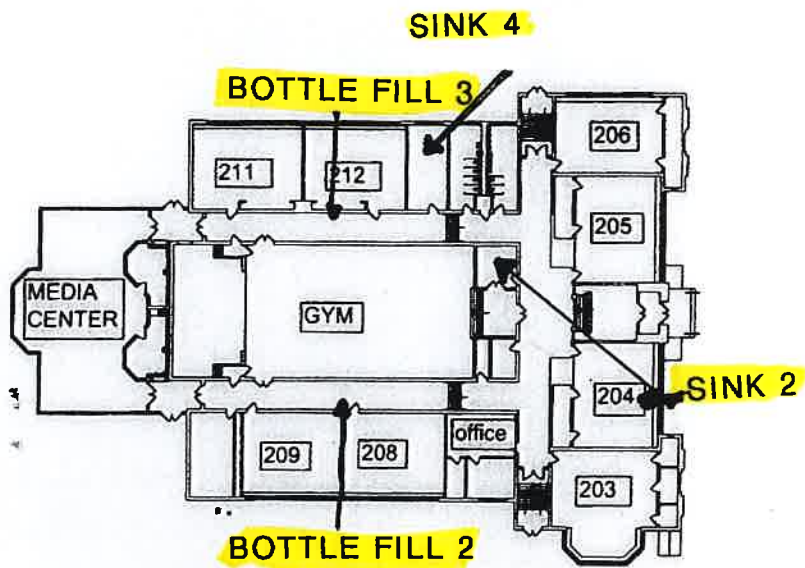

BYRD E.S.
LOWER LEVEL

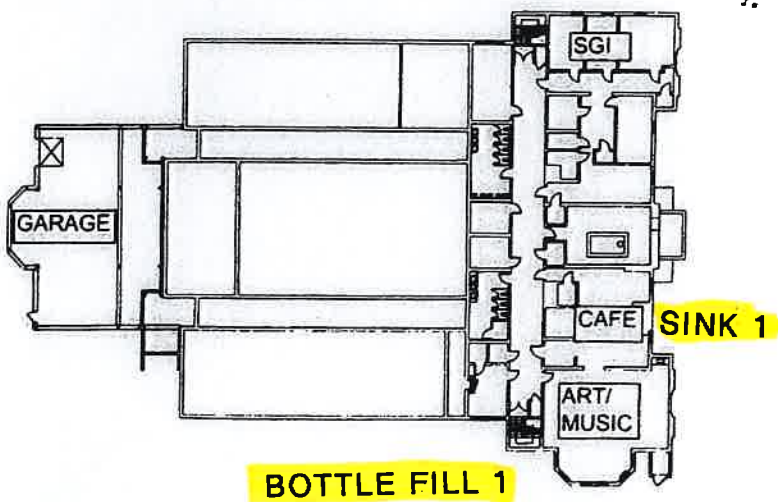

BYRD SCHOOL

Appendix E Laboratory Data



Environmental Hazards Services, L.L.C.
7469 Whitepine Rd
Richmond, VA 23237
Telephone: 800.347.4010

Lead in Drinking Water Analysis Report

Client: LEW Corp
181 US Hwy 46
Mine Hill, NJ 07803

Report Number: 22-03-03042

Received Date: 03/14/2022
Reported Date: 03/21/2022
Sampled By: Andrew Wong
Tech Certification #:

Project/Test Address: 220156; Alexander Hamilton Elementary School; 380 Harristown Road; Glen
Rock, NJ 07452

Client Number:
201327

Laboratory Results

Fax Number:
Ext 18 Melissa

Lab Sample Number	Client Sample ID	Collection Date	Collection Location	Concentration ug/L (ppb)	Analysis Date	Narrative ID
22-03-03042-001	AH-S3-NO	03/12/2022	SINK NURSE OFFICE	<1.00	03/18/2022	
22-03-03042-002	AH-S2-MO	03/12/2022	SINK MAIN OFFICE	<1.00	03/18/2022	
22-03-03042-003	AH-S4-126	03/12/2022	SINK CLASSROOM 126	<1.00	03/18/2022	
22-03-03042-004	AH-S5-124	03/12/2022	SINK CLASSROOM 124	<1.00	03/18/2022	
22-03-03042-005	AH-S1-FR	03/12/2022	SINK FACULTY ROOM	<1.00	03/18/2022	
22-03-03042-006	AH-BF2-SB	03/12/2022	BOTTLE FILL NEXT TO STUDENT BATHROOM	<1.00	03/18/2022	
22-03-03042-007	AH-S-SR	03/12/2022	SINK SUNROOM	<1.00	03/18/2022	

Environmental Hazards Services, L.L.C

Client Number: 201327

Report Number: 22-03-03042

Project/Test Address: 220156; Alexander Hamilton Elementary School; 380
Harristown Road; Glen Rock, NJ 07452

Lab Sample Number	Client Sample ID	Collection Date	Collection Location	Concentration ug/L (ppb)	Analysis Date	Narrative ID
----------------------	---------------------	--------------------	---------------------	-----------------------------	------------------	-----------------

Method: EPA 200.8

Analyst: Anthony Dee

Accreditation #: NJ VA008

Reviewed By Authorized Signatory:

Melissa Kanode

Melissa Kanode

QA/QC Clerk

Sample Results denoted with a "less than" (<) sign contain less than the reporting limit which is 1 ppb.

The EPA Maximum Contaminant Level for Lead in Drinking Water is 15 ppb. The results herein conform to NELAC standards, where applicable, unless otherwise narrated on this report. Results represent the analysis of samples submitted by the client. Sample location, description, field parameter results, etc., were provided by the client. This report cannot be reproduced, except in full, without written approval from Environmental Hazards Services, L.L.C.

LEGEND ug/L= micrograms per liter ppb = parts per billion



EHS Laboratories

ENVIRONMENTAL HAZARDS SERVICES, LLC

Water Chain-of-Custody Form

SHIP TO: 7469 Whitepine Rd. Richmond, VA 23237

Phone: (800) 347-4010 FAX: (804) 275-4907

ONLINE CLIENT PORTAL AVAILABLE FOR ANALYSIS RESULTS AT: www.leadlab.com

22-03-03042



Due Date:

03/21/2022

(Monday)

AE



Company Name: LEW CORP Account #: 201327

Address: 181 US Highway 46 City/State/Zip: Mine Hill, NJ 07803

Phone: (908-654-8068) Email: labresults@lewcorp.com Fax: 908-654-8069

Project Name / Collection Address: ALEXANDER HAMILTON 380 HARRISTOWN ROAD City/State/Zip: GLEN ROCK, NJ, 07452
(Required) (Required)

Project #: 220156 Sampled By: ANDREW WONG License # (If Required): _____

Water Source: (Check One) Public ☒ Well _____ Well Tag # (If Applicable): _____
(Required)

No.	Client Sample ID	Collection Location (Ex: Kitchen Sink)	Collection Date	Collection Time	Metals			Field Parameters		LAB USE
					Lead	Copper	Other	Field pH at time of Collection:	Temp. at time of Collection:	Temp at Time of Receipt:
1	AH-S3-MO	SINK - NURSE OFFICE	3/12/22	7:00 PM	X					
2	- S2-MO	- MAIN OFFICE		AM / PM						
3	- S4-126	- CLASSROOM 126		AM / PM						
4	- S5-124	- ↓ 124		AM / PM						
5	- S1-FR	↓ - FACULTY ROOM		AM / PM						
6	↓ - BF2-SB	BOTTLE FILL - NEXT TO STUDENT BATHROOM		AM / PM						
7	↓ - S-SR	SINK - SUN ROOM		AM / PM						
8				AM / PM						
9				AM / PM						
10				AM / PM						

Released by: Andrew Wong Signature: [Signature]
Released by: _____ Signature: _____

Rec: Amy Vejnar

[Signature]



Environmental Hazards Services, L.L.C.
7469 Whitepine Rd
Richmond, VA 23237
Telephone: 800.347.4010

Lead in Drinking Water Analysis Report

Client: LEW Corp
181 US Hwy 46
Mine Hill, NJ 07803

Report Number: 22-03-02916

Received Date: 03/14/2022
Reported Date: 03/21/2022
Sampled By: Andrew Wong
Tech Certification #:

Project/Test Address: 220156; Central ES; 600 S Maple Avenue; Glen Rock, NJ 07542

Client Number:
201327

Laboratory Results

Fax Number:
Ext 18 Melissa

Lab Sample Number	Client Sample ID	Collection Date	Collection Location	Concentration ug/L (ppb)	Analysis Date	Narrative ID
22-03-02916-001	CS-BF1-RM103	03/12/2022	BOTTLE FILL OUTSIDE ROOM 103	<1.00	03/18/2022	
22-03-02916-002	CS-S4-RM100	03/12/2022	SINK ROOM 100	1.03	03/18/2022	
22-03-02916-003	CS-S5-RM101	03/12/2022	SINK ROOM 101	1.31	03/18/2022	
22-03-02916-004	CS-S1-NO	03/12/2022	SINK NURSE OFFICE	<1.00	03/18/2022	
22-03-02916-005	CS-BF3-RM212	03/12/2022	BOTTLE FILL OUTSIDE ROOM 212	<1.00	03/18/2022	
22-03-02916-006	CS-BF2-RM205	03/12/2022	BOTTLE FILL OUTSIDE ROOM 205	<1.00	03/18/2022	
22-03-02916-007	CS-S2-215	03/12/2022	SINK CLASSROOM 215	<1.00	03/18/2022	
22-03-02916-008	CS-S3-214	03/12/2022	SINK CLASSROOM 214	<1.00	03/18/2022	
22-03-02916-009	CS-BF4-RM306	03/12/2022	BOTTLE FILL OUTSIDE ROOM 306	<1.00	03/18/2022	
22-03-02916-010	CS-S-SR	03/12/2022	SINK SUNROOM	<1.00	03/18/2022	

Environmental Hazards Services, L.L.C

Client Number: 201327

Report Number: 22-03-02916

Project/Test Address: 220156; Central ES; 600 S Maple Avenue; Glen Rock,
NJ 07542

Lab Sample Number	Client Sample ID	Collection Date	Collection Location	Concentration ug/L (ppb)	Analysis Date	Narrative ID
----------------------	---------------------	--------------------	---------------------	-----------------------------	------------------	-----------------

Method: EPA 200.8

Analyst: Anthony Dee

Accreditation #: NJ VA008

Reviewed By Authorized Signatory:

Melissa Kanode

Melissa Kanode

QA/QC Clerk

Sample Results denoted with a "less than" (<) sign contain less than the reporting limit which is 1 ppb.

The EPA Maximum Contaminant Level for Lead in Drinking Water is 15 ppb. The results herein conform to NELAC standards, where applicable, unless otherwise narrated on this report. Results represent the analysis of samples submitted by the client. Sample location, description, field parameter results, etc., were provided by the client. This report cannot be reproduced, except in full, without written approval from Environmental Hazards Services, L.L.C.

LEGEND ug/L= micrograms per liter ppb = parts per billion



ENVIRONMENTAL HAZARDS SERVICES, LLC

Water Chain-of-Custody Form

SHIP TO: 7469 Whitepine Rd. Richmond, VA 23237

Phone: (800) 347-4010 FAX: (804) 275-4907

ONLINE CLIENT PORTAL AVAILABLE FOR ANALYSIS RESULTS AT: www.leadlab.com

22-03-02916



Due Date:
03/21/2022
(Monday)
AE



Company Name: LEW CORP Account #: 201327

Address: 181 US Highway 46 City/State/Zip: Mine Hill, NJ 07803

Phone: (908-654-8068) Email: labresults@lewcorp.com Fax: 908-654-8069

Project Name / Collection Address: CENTRAL E.S. 600 S. MAPLE AVENUE City/State/Zip: GLEN ROCK, NJ, 07542
(Required)

Project #: 220156 Sampled By: ANDREW WONG License # (If Required): _____

Water Source: (Check One) Public ☒ Well _____ Well Tag # (If Applicable): _____

X		5 Day Turnaround	3 Day Turnaround	2 Day Turnaround	1 Day Turnaround	Call Ahead				
No.	Client Sample ID	Collection Location (Ex: Kitchen Sink)	Collection Date	Collection Time	Metals			Field Parameters		LAB USE
					Lead	Copper	Other	Field pH at time of Collection:	Temp. at time of Collection:	Temp at Time of Receipt:
1	CS-BF1-RM103	BOTTLE FILL - OUTSIDE ROOM 103	3/12/22	7 AM/PM	X					
2	-S4-RM100	SINK - Room 100		AM/PM						
3	-S5-RM101	↓ - ↓ 101		AM/PM						
4	-S1-ND	↓ - NURSE OFFICE		AM/PM						
5	-BF3-RM212	BOTTLE FILL - OUTSIDE ROOM 212		AM/PM						
6	-BF2-RM205	↓ - OUTSIDE ROOM 205		AM/PM						
7	-S2-215	SINK - CLASSROOM 215		AM/PM						
8	-S3-214	↓ ↓ 214		AM/PM						
9	↓ BF4-RM306	BOTTLE FILL - OUTSIDE ROOM 306		AM/PM						
10	↓ S-SR	SINK - SUN ROOM		AM/PM						
Released by: <u>Andrew Wong</u>			Signature: <u>[Signature]</u>			Date/Time: <u>3/12/22 7AM</u>				
Released by: _____			Signature: _____			Date/Time: _____				

Rec: Amy Vegner

[Signature]

3/14/22

11:05AM



Environmental Hazards Services, L.L.C.
7469 Whitepine Rd
Richmond, VA 23237
Telephone: 800.347.4010

Lead in Drinking Water Analysis Report

Client: LEW Corp
181 US Hwy 46
Mine Hill, NJ 07803

Report Number: 22-03-02934

Received Date: 03/14/2022
Reported Date: 03/21/2022
Sampled By: Andrew Wong
Tech Certification #:

Project/Test Address: 220156; Clara E Coleman ES; 100 Pinelynn Road; Glen Rock, NJ 07452

Client Number:
201327

Laboratory Results

Fax Number:
Ext 18 Melissa

Lab Sample Number	Client Sample ID	Collection Date	Collection Location	Concentration ug/L (ppb)	Analysis Date	Narrative ID
22-03-02934-001	CES-BF3-FR	03/12/2022	BOTTLE FILL OUTSIDE FACULTY ROOM	<1.00	03/18/2022	
22-03-02934-002	CES-S7-FR	03/12/2022	SINK FACULTY ROOM	1.16	03/18/2022	
22-03-02934-003	CES-S1-NO	03/12/2022	SINK NURSE OFFICE	2.95	03/18/2022	
22-03-02934-004	CES-S2-RMK2	03/12/2022	SINK CLASSROOM K2	<1.00	03/18/2022	
22-03-02934-005	CES-S3-RMK1	03/12/2022	SINK CLASSROOM K1	<1.00	03/18/2022	
22-03-02934-006	CES-S4-K	03/12/2022	SINK KITCHEN	3.05	03/18/2022	
22-03-02934-007	CES-S5-RM5	03/12/2022	SINK CLASSROOM 5	<1.00	03/18/2022	
22-03-02934-008	CES-S6-RM4A	03/12/2022	SINK CLASSROOM 4A	<1.00	03/21/2022	W01
22-03-02934-009	CES-BF2-RM11	03/12/2022	BOTTLE FILL OUTSIDE ROOM 11	<1.00	03/18/2022	
22-03-02934-010	CES-BF1-MC	03/12/2022	BOTTLE FILL OUTSIDE MEDIA CENTER	<1.00	03/18/2022	
22-03-02934-011	CES-S-SR	03/12/2022	SUNROOM SINK	<1.00	03/18/2022	

Sample Narratives:

W01: MB exceeded acceptance limit for Pb conc 0.118 ppb.

Environmental Hazards Services, L.L.C

Client Number: 201327

Report Number: 22-03-02934

Project/Test Address: 220156; Clara E Coleman ES; 100 Pinelynn Road; Glen Rock, NJ 07452

Lab Sample Number	Client Sample ID	Collection Date	Collection Location	Concentration ug/L (ppb)	Analysis Date	Narrative ID
-------------------	------------------	-----------------	---------------------	--------------------------	---------------	--------------

Method: EPA 200.8

Analyst: Anthony Dee

Accreditation #: NJ VA008

Reviewed By Authorized Signatory:

Melissa Kanode

Melissa Kanode

QA/QC Clerk

Sample Results denoted with a "less than" (<) sign contain less than the reporting limit which is 1 ppb.

The EPA Maximum Contaminant Level for Lead in Drinking Water is 15 ppb. The results herein conform to NELAC standards, where applicable, unless otherwise narrated on this report. Results represent the analysis of samples submitted by the client. Sample location, description, field parameter results, etc., were provided by the client. This report cannot be reproduced, except in full, without written approval from Environmental Hazards Services, L.L.C.

LEGEND ug/L= micrograms per liter ppb = parts per billion



Laboratories™

ENVIRONMENTAL HAZARDS SERVICES, LLC

Water Chain-of-Custody Form

SHIP TO: 7469 Whitepine Rd. Richmond, VA 23237

Phone: (800) 347-4010 FAX: (804) 275-4907

ONLINE CLIENT PORTAL AVAILABLE FOR ANALYSIS RESULTS AT: www.leadlab.com

22-03-02934



Due Date:

03/21/2022

(Monday)

AE



Company Name: LEW CORP Account #: 201327

Address: 181 US Highway 46 City/State/Zip: Mine Hill, NJ 07803

Phone: (908-654-8068) Email: labresults@lewcorp.com Fax: 908-654-8069

Project Name / Collection Address: CLARA E. COLEMAN E.S.

(Required) 100 PINELYNN ROAD City/State/Zip: GLEN ROCK, NJ, 07452

Project #: 220156 Sampled By: ANDREW WONG License # (If Required):

Water Source: (Check One) Public ☒ Well ☐ Well Tag # (If Applicable):

<input checked="" type="checkbox"/> 5 Day Turnaround		<input type="checkbox"/> 3 Day Turnaround		<input type="checkbox"/> 2 Day Turnaround		<input type="checkbox"/> 1 Day Turnaround Call Ahead				
No.	Client Sample ID	Collection Location (Ex: Kitchen Sink)	Collection Date	Collection Time	Metals			Field Parameters		LAB USE
					Lead	Copper	Other	Field pH at time of Collection:	Temp. at time of Collection:	Temp at Time of Receipt:
1	CES-BF3-FR	BOTTLE FILL- ^{OUTSIDE} FACULTY ROOM	3/12/22	7 ^{AM} PM	X					
2	- S7-FR	SINK - FACULTY ROOM		AM / PM						
3	- S1-ND	- NURSE OFFICE		AM / PM						
4	- S2-RMK2	- CLASSROOM K2		AM / PM						
5	- S3-RMK1	↓ K1		AM / PM						
6	- S4-K	- KITCHEN		AM / PM						
7	- S5-RM5	- CLASSROOM ^{AD} 5		AM / PM						
8	- S6-RM4A	↓ - ↓ 4A		AM / PM						
9	- BF2-RM11	BOTTLE FILL- ^{OUTSIDE} ROOM 11		AM / PM						
10	↓ - BF1-MC	BOTTLE FILL- ^{OUTSIDE} MEDIA CENTER	↓	AM / PM	↓					
Released by: <u>ANDREW WONG</u>			Signature: <u>[Signature]</u>			Date/Time: <u>3/12/22</u> <u>7 AM</u>				
Released by:			Signature:			Date/Time:				

11 CES-SR SUN ROOM SINK

cc: Amy Vejnar

[Signature]

3/14/22 11:23 AM



Environmental Hazards Services, L.L.C.
7469 Whitepine Rd
Richmond, VA 23237
Telephone: 800.347.4010

Lead in Drinking Water Analysis Report

Client: LEW Corp
181 US Hwy 46
Mine Hill, NJ 07803

Report Number: 22-03-02897

Received Date: 03/14/2022
Reported Date: 03/21/2022
Sampled By: Andrew Wong
Tech Certification #:

Project/Test Address: 220156; Glen Rock High School; 400 Hamilton Avenue; Glen Rock, NJ 07452

Client Number:
201327

Laboratory Results

Fax Number:
Ext 18 Melissa

Lab Sample Number	Client Sample ID	Collection Date	Collection Location	Concentration ug/L (ppb)	Analysis Date	Narrative ID
22-03-02897-001	GRHS-BF6-PO	03/12/2022	BOTTLE FILL OUTSIDE PRINCIPAL'S OFFICE	<1.00	03/18/2022	
22-03-02897-002	GRHS-BF1-NO	03/12/2022	BOTTLE FILL NURSES OFFICE	<1.00	03/18/2022	
22-03-02897-003	GRHS-S1-CAF	03/12/2022	SINK CAFETERIA	1.19	03/18/2022	
22-03-02897-004	GRHS-S5-CAFG	03/12/2022	SINK CAFETERIA	3.12	03/18/2022	
22-03-02897-005	GRHS-S7-CS	03/12/2022	SINK CHILDS STUDY	<1.00	03/18/2022	
22-03-02897-006	GRHS-S8-WR	03/12/2022	SINK WORK ROOM	<1.00	03/18/2022	
22-03-02897-007	GRHS-BF2-GL	03/12/2022	BOTTLE FILL GYM LOBBY	<1.00	03/18/2022	
22-03-02897-008	GRHS-BF7-116	03/12/2022	BOTTLE FILL OUTSIDE S116	<1.00	03/18/2022	
22-03-02897-009	GRHS-S2-HE	03/12/2022	SINK HOME ECONOMICS	<1.00	03/18/2022	
22-03-02897-010	GRHS-S3-HE	03/12/2022	SINK HOME ECONOMICS	<1.00	03/18/2022	
22-03-02897-011	GRHS-BF3-MSG	03/12/2022	BOTTLE FILL OUTSIDE MIDDLE SCHOOL GYM	<1.00	03/18/2022	
22-03-02897-012	GRHS-S4-MSFR	03/12/2022	SINK MIDDLE SCHOOL FACUCTY ROOM	<1.00	03/18/2022	
22-03-02897-013	GRHS-BF4-A210	03/12/2022	BOTTLE FILL OUTSIDE ROOM A210	<1.00	03/18/2022	

Environmental Hazards Services, L.L.C

Client Number: 201327

Report Number: 22-03-02897

Project/Test Address: 220156; Glen Rock High School; 400 Hamilton Avenue;
Glen Rock, NJ 07452

Lab Sample Number	Client Sample ID	Collection Date	Collection Location	Concentration ug/L (ppb)	Analysis Date	Narrative ID
22-03-02897-014	GRHS-BF5-S232	03/12/2022	BOTTLE FILL OUTSIDE ROOM S232	<1.00	03/18/2022	
22-03-02897-015	GRHS-S8-SHOP	03/12/2022	SHOP SINK	<1.00	03/18/2022	
22-03-02897-016	GRHS-S-SR	03/12/2022	SINK SUNROOM	<1.00	03/18/2022	

Method: EPA 200.8

Analyst: Anthony Dee

Accreditation #: NJ VA008

Reviewed By Authorized Signatory:



Melissa Kanode

QA/QC Clerk

Sample Results denoted with a "less than" (<) sign contain less than the reporting limit which is 1 ppb.

The EPA Maximum Contaminant Level for Lead in Drinking Water is 15 ppb. The results herein conform to NELAC standards, where applicable, unless otherwise narrated on this report. Results represent the analysis of samples submitted by the client. Sample location, description, field parameter results, etc., were provided by the client. This report cannot be reproduced, except in full, without written approval from Environmental Hazards Services, L.L.C.

LEGEND ug/L= micrograms per liter ppb = parts per billion



Laboratories™
ENVIRONMENTAL HAZARDS SERVICES, LLC

Water Chain-of-Custody Form

SHIP TO: 7469 Whitepine Rd. Richmond, VA 23237

Phone: (800) 347-4010 FAX: (804) 275-4907

ONLINE CLIENT PORTAL AVAILABLE FOR ANALYSIS RESULTS AT: www.leadlab.com

22-03-02897



Due Date:
03/21/2022
(Monday)
AE



Company Name: LEW CORP Account #: 201327
Address: 181 US Highway 46 City/State/Zip: Mine Hill, NJ 07803
Phone: (908-654-8068) Email: labresults@lewcorp.com Fax: 908-654-8069

Project Name / Collection Address: GLEN ROCK HIGH SCHOOL 400 HAMILTON AVENUE City/State/Zip: GLEN ROCK, NJ, 07452
(Required)
Project #: 220156 Sampled By: ANDREW WONG License # (If Required): _____

Water Source: (Check One) Public ☒ Well _____ Well Tag # (If Applicable): _____
(Required)

<input checked="" type="checkbox"/> 5 Day Turnaround		<input type="checkbox"/> 3 Day Turnaround		<input type="checkbox"/> 2 Day Turnaround		<input type="checkbox"/> 1 Day Turnaround / Call Ahead				
No.	Client Sample ID	Collection Location (Ex: Kitchen Sink)	Collection Date	Collection Time	Metals			Field Parameters		LAB USE
					Lead	Copper	Other	Field pH at time of Collection:	Temp. at time of Collection:	Temp at Time of Receipt:
1	GRHS-BF6-PD	BOTTLE FILL - OUTSIDE PRINCIPAL'S OFFICE	3/12/22	7:00 PM	X					
2	-BF1-ND	BOTTLE FILL - NURSE'S OFFICE		AM / PM						
3	S1-CAF	SINK - CAFETERIA		AM / PM						
4	-S5-CAF	SINK - CAFETERIA		AM / PM						
5	-S7-CS	SINK - CHILD STUDY		AM / PM						
6	-S8-WR	SINK - WORK ROOM		AM / PM						
7	-BF2-GL	BOTTLE FILL - GYM LOBBY		AM / PM						
8	-BF7-116	BOTTLE FILL - OUTSIDE S116		AM / PM						
9	-S2-HE	SINK - HOME ECONOMICS		AM / PM						
10	V-S3-HE	SINK - HOME ECONOMICS		AM / PM						

Released by: ANDREW WONG

Signature: [Signature]

Date/Time: 3/12/22 7 AM

Released by:

Signature: [Signature]

Date/Time:

Rec: Amy Vejnar

[Signature]

3/14/22 10:54 AM



Laboratories™

ENVIRONMENTAL HAZARDS SERVICES, LLC

Water Chain-of-Custody Form

SHIP TO: 7469 Whitepine Rd. Richmond, VA 23237

Phone: (800) 347-4010 FAX: (804) 275-4907

ONLINE CLIENT PORTAL AVAILABLE FOR ANALYSIS RESULTS AT: www.leadlab.com

~ For Lab Use Only ~

Company Name: LEW CORP Account #: 201327

Address: 181 US Highway 46 City/State/Zip: Mine Hill, NJ 07803

Phone: (908-654-8068) Email: labresults@lewcorp.com Fax: 908-654-8069

Project Name / Collection Address: 400 HAMILTON AVENUE City/State/Zip: GEN ROCK, NJ, 07452
(Required) (Required)

Project #: 220156 Sampled By: ANDREW WONG License # (If Required): _____

Water Source: (Check One) Public X Well _____ Well Tag # (If Applicable): _____
(Required)

<input checked="" type="checkbox"/> 5 Day Turnaround		<input type="checkbox"/> 3 Day Turnaround		<input type="checkbox"/> 2 Day Turnaround		<input type="checkbox"/> 1 Day Turnaround *Call Ahead				
No.	Client Sample ID	Collection Location (Ex: Kitchen Sink)	Collection Date	Collection Time	Metals			Field Parameters		LAB USE
					Lead	Copper	Other	Field pH at time of Collection:	Temp. at time of Collection:	Temp at Time of Receipt:
1	GRHS-BF3-MSG	BOTTLE FILL - OUTSIDE MIDDLE SCHOOL GYM	3/12/22	7:00 AM	X					
2	-S4-MSFR	SINK - MIDDLE SCHOOL FACULTY ROOM	↓	AM / PM						
3	-BF4-A210	BOTTLE FILL - OUTSIDE ROOM A210		AM / PM						
4	-BF5-S232	BOTTLE FILL - OUTSIDE ROOM S232		AM / PM						
5	-S8-shop	SHOP SINK		AM / PM						
6	-S-SR	SINK - SUN ROOM		AM / PM						
7				AM / PM						
8				AM / PM						
9				AM / PM						
10				AM / PM						

Released by: ANDREW WONG

Released by: _____

Signature: [Signature]

Signature: [Signature]

Date/Time: 3/12/22 7 AM

Date/Time: _____

Rec: Amy Vejnar

[Signature]

3/14/22 10:55 AM



Environmental Hazards Services, L.L.C.
7469 Whitepine Rd
Richmond, VA 23237
Telephone: 800.347.4010

Lead in Drinking Water Analysis Report

Client: LEW Corp
181 US Hwy 46
Mine Hill, NJ 07803

Report Number: 22-03-02949
Received Date: 03/14/2022
Reported Date: 03/21/2022
Sampled By: Andrew Wong
Tech Certification #:

Project/Test Address: 220156; Richard E Byrd School; 640 Doremus Ave; Glen Rock, NJ 07452

Client Number:
201327

Laboratory Results

Fax Number:
Ext 18 Melissa

Lab Sample Number	Client Sample ID	Collection Date	Collection Location	Concentration ug/L (ppb)	Analysis Date	Narrative ID
22-03-02949-001	BES-S1-CAFE	03/12/2022	SINK CAFE FIRST FLOOR	1.17	03/18/2022	
22-03-02949-002	BES-BF1-1FLR	03/12/2022	BOTTLE FILL MIDDLE OF FIRST FLOOR	<1.00	03/18/2022	
22-03-02949-003	BES-BF2-RM212	03/12/2022	BOTTLE FILL OUTSIDE OF ROOM 212	<1.00	03/18/2022	
22-03-02949-004	BES-BF3-RM209	03/12/2022	BOTTLE FILL OUTSIDE OF ROOM 209	<1.00	03/18/2022	
22-03-02949-005	BES-S2-CR	03/12/2022	SINK COPY ROOM	<1.00	03/18/2022	
22-03-02949-006	BES-S3-FR	03/12/2022	SINK FACULTY ROOM	<1.00	03/18/2022	
22-03-02949-007	BES-S4-NO	03/12/2022	SINK NURSE OFFICE	2.28	03/18/2022	
22-03-02949-008	BES-RM304	03/12/2022	BOTTLE FILL OUTSIDE OF ROOM 304	<1.00	03/18/2022	
22-03-02949-009	BES-S-SR	03/12/2022	SINK SUNROOM	<1.00	03/18/2022	

Environmental Hazards Services, L.L.C

Client Number: 201327

Report Number: 22-03-02949

Project/Test Address: 220156; Richard E Byrd School; 640 Doremus Ave;
Glen Rock, NJ 07452

Lab Sample Number	Client Sample ID	Collection Date	Collection Location	Concentration ug/L (ppb)	Analysis Date	Narrative ID
----------------------	---------------------	--------------------	---------------------	-----------------------------	------------------	-----------------

Method: EPA 200.8

Analyst: Anthony Dee

Accreditation #: NJ VA008

Reviewed By Authorized Signatory:

Melissa Kanode

Melissa Kanode

QA/QC Clerk

Sample Results denoted with a "less than" (<) sign contain less than the reporting limit which is 1 ppb.

The EPA Maximum Contaminant Level for Lead in Drinking Water is 15 ppb. The results herein conform to NELAC standards, where applicable, unless otherwise narrated on this report. Results represent the analysis of samples submitted by the client. Sample location, description, field parameter results, etc., were provided by the client. This report cannot be reproduced, except in full, without written approval from Environmental Hazards Services, L.L.C.

LEGEND ug/L= micrograms per liter ppb = parts per billion



EHS Laboratories
ENVIRONMENTAL HAZARDS SERVICES, LLC

Water Chain-of-Custody Form

SHIP TO: 7469 Whitepine Rd. Richmond, VA 23237

Phone: (800) 347-4010 FAX: (804) 275-4907

ONLINE CLIENT PORTAL AVAILABLE FOR ANALYSIS RESULTS AT: www.leadlab.com

22-03-02949



Due Date:

03/21/2022

(Monday)

AE

Handwritten mark

Company Name: LEW CORP Account #: 201327

Address: 181 US Highway 46 City/State/Zip: Mine Hill, NJ 07803

Phone: (908-654-8068) Email: labresults@lewcorp.com Fax: 908-654-8069

Project Name / Collection Address: RICHARD E. BYRD SCHOOL City/State/Zip: GLEN ROCK, NJ, 07452
(Required) 640 DOREMUS AVE, (Required)

Project #: 220156 Sampled By: ANDREW WONG License # (If Required):

Water Source: (Check One) Public X Well _____ Well Tag # (If Applicable): _____

		5 Day Turnaround		3 Day Turnaround		2 Day Turnaround		1 Day Turnaround		Call Ahead	
No.	Client Sample ID	Collection Location (Ex: Kitchen Sink)	Collection Date	Collection Time	Metals			Field Parameters		LAB USE	
					Lead	Copper	Other	Field pH at time of Collection:	Temp. at time of Collection:	Temp at Time of Receipt:	
1	BES - S1 - CAFE	SINK - CAFE FIRST FLOOR	3/12/22	7 00 AM PM	X						
2	-BF1-1LR	BOTTLE FILL - MIDDLE OF FIRST FLOOR									
3	-BF2-RM212	BOTTLE FILL - OUTSIDE OF ROOM 212									
4	-BF3-RM209	BOTTLE FILL - OUTSIDE OF ROOM 209									
5	-S2-CR	SINK - COPY ROOM									
6	-S3-CR	SINK - FACULTY ROOM									
7	-S4-ND	SINK - NURSE OFFICE									
8	BH4-RM304	BOTTLE FILL - OUTSIDE OF ROOM 304									
9	S-SR	SINK - SUN ROOM									
10											

Released by: ANDREW WONG

Signature: Andrew Wong

Date/Time: 3/12/22 7 AM

Released by:

Signature:

Date/Time:

Rec: Amy Vejnar

Handwritten signature

3/14/22

11:22